

WWL30-150CT

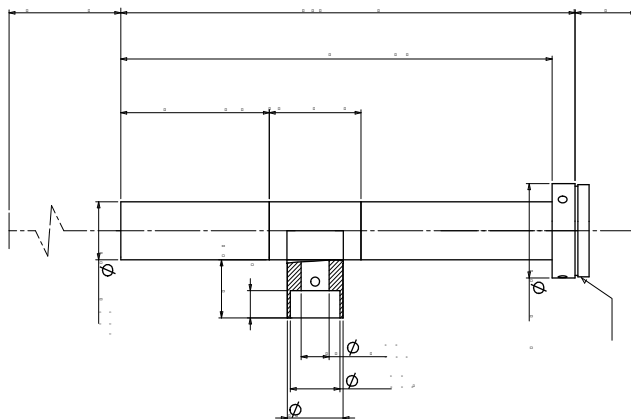

WWL

•	/	(x)	3.0
•	Ø16mm	WD(mm)	150
•		CCD (mm)	6.0(1/3")
•		F/#	45.5
•		NA	0.03329
		(um)	10.1
		(mm)	0.4

(mm x mm)

		1/4" (3.2x2.4)	1.1x0.8
(mm)	128.8	1/3" (4.8x3.6)	1.6x1.2

