

DTCM430-26-AL

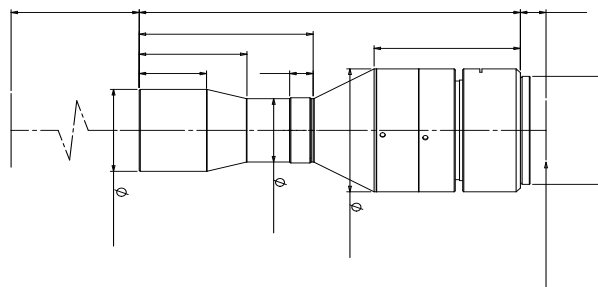

- DTCM
- FOV 26mm 300mm
- 4/3" ~ 59mm M/F
-
-

FOV(mm)	26
(x)	0.923
WD(mm)	73±1
CCD (mm)	24(4/3")
F/#	12.5
MTF30 (lp/mm)	>65
DoF(mm)	±0.9@F20
(% max)	<0.1
(° max)	<0.1
I/O(mm)	264±1

DTCL-26-xW-y

26mm



(mm x mm)

	M42/M48/M58	4/3"	21M (17.86x14.32)	19.3x15.5
(mm)	178.5	4/3" PYTHON 12K (18.43x13.82)		20.0x15.0
(kg)	0.8	4/3" CMV8000 (18.48x13.73)		20.0x14.9