

DTCM430-150-AL

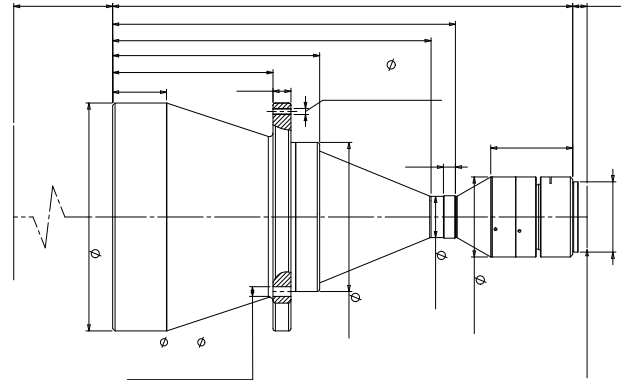

- DTCM
- FOV 26mm 300mm
- 4/3" ~ 59mm M/F
-
-

FOV(mm)	150
(x)	0.160
WD(mm)	300±5
CCD (mm)	24(4/3")
F/#	8.1
MTF30 (lp/mm)	>115
DoF(mm)	±25.0@F16
(% max)	<0.1
(° max)	<0.1
I/O(mm)	697±5

DTCL-150-xW-y

150mm



(mm x mm)

	M42/M48/M58	4/3"	21M (17.86x14.32)	111.6x89.5
(mm)	384.5	4/3" PYTHON 12K (18.43x13.82)		115.2x86.4
(kg)	6.2	4/3" CMV8000 (18.48x13.73)		115.5x85.8