

DTCM125-110-AL

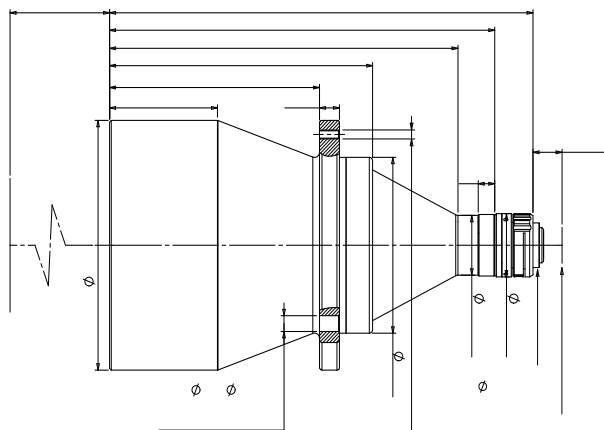

DTCM

-
- FOV 26mm 300mm
- 1/2.5" ~ 1.1" C
-

FOV(mm)	110
(x)	0.066
WD(mm)	263±4
CCD (mm)	7.2(1/2.5")
F/#	4.2
MTF30 (lp/mm)	>210
DoF(mm)	±101@F11
(% max)	<0.1
(° max)	<0.1
I/O(mm)	536±4

DTCL-110-xW-y

110mm



(mm x mm)

	C
(mm)	255.1
(kg)	2.7

1/3" AR130/RJ33 (4.8x3.6)	72.7x54.5
1/2.5" 9P001/31 (5.7x4.28)	86.4x64.8

